

PROJECT DATA	
TOTAL PROJECT AREA	43.44± ACRES
MIXED USE	25.14± ACRES (24.16± ACRES)
LIGHT INDUSTRIAL	7.85± ACRES (8.83± ACRES)*
RIGHT-OF-WAY	10.45± ACRES

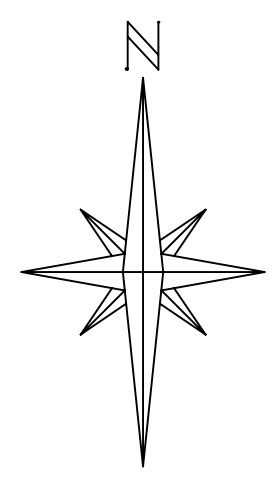
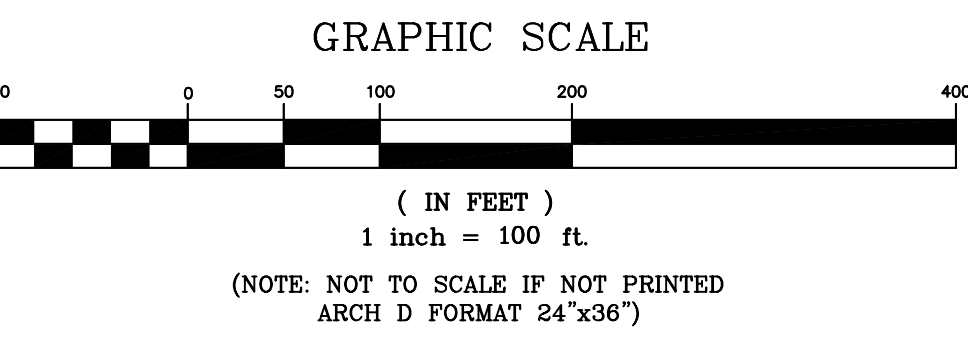
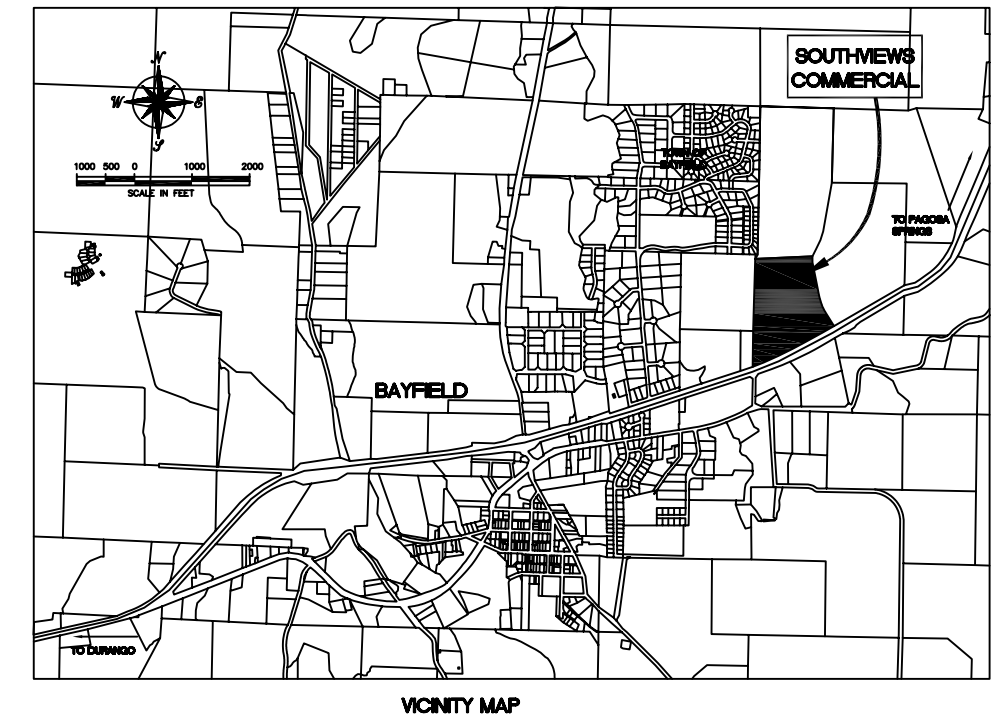

U.S. HWY.  
160b

U.S. HWY. 160

**SOUTHVIEWS COMMERCIAL  
MASTER PLAN**

BAYFIELD  
LA PLATA COUNTY, CO  
LOCATED IN THE E1/2 of SECTION 1 TOWNSHIP 34 NORTH, RANGE 7 WEST,  
N.M.P.M.

PREP'D BY:	WHF	CHECK'D BY:	RBE
OWNER/APPLICANT:	REAL ESTATE VENTURES II, L.L.C.	SHEET NO.:	1 OF 1
DATE ISSUED:	06/19/08	REVISION DATE:	06/30/08